

## INSTALLATION GUIDE

# SOFT BED 4GS WINGS ■ 8GS WINGS

The HT 4GS WINGS and HT 8GS WINGS soft beds have been developed for use in free stalls with a slight slope and self-supporting dividers. They consist of an endless rubber top-cover sheet and composite foam sheets specially developed for dairy farming.



### Tools & Accessories

- ✓ Measuring tape or metre rule
- ✓ Chalk or pencil for marking (chalk line if necessary)
- ✓ Tensioning device incl. chain hoists/tensioning straps
- ✓ Drill with Ø 10mm & 11-12 mm drill bit
- ✓ Hammer drill with Ø 10 mm drill bit
- ✓ Hammer
- ✓ Knife
- ✓ Bit Torx TX25 & TX40



### Fastening elements

- ✓ Nail-in anchor A2 10x80 with special washer
- ✓ End fastening for WINGS systems consisting of:
  - 1 Pair of plastic bars,
  - 5x plastic dowels 10x100mm,
  - 5x pan washer head screws 8x100mm (A2),
  - 2 stainless steel clamping strip,
  - stainless steel screws 5x40mm or 5x30mm

#### End fastening WINGS system

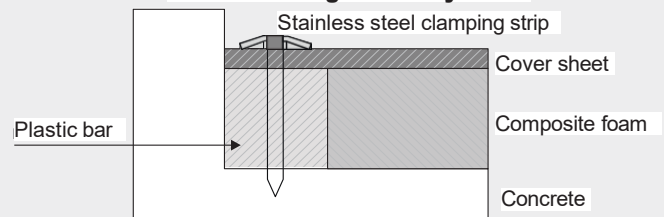

### Requirements

- ✓ Store the endless rubber top-cover sheet on the installation surface for at least 48 hours, or at room temperature for 7 days before installation, so it reaches a uniform temperature.
- ✓ Do not install at ambient temperatures below 10°C ( 50°F ).



### Requirements substrate / concrete

- ✓ Level, firm, clean, dry and free of holes, bumps or raised edges.

Updated: August ,2025

## 1 Check plastic bar

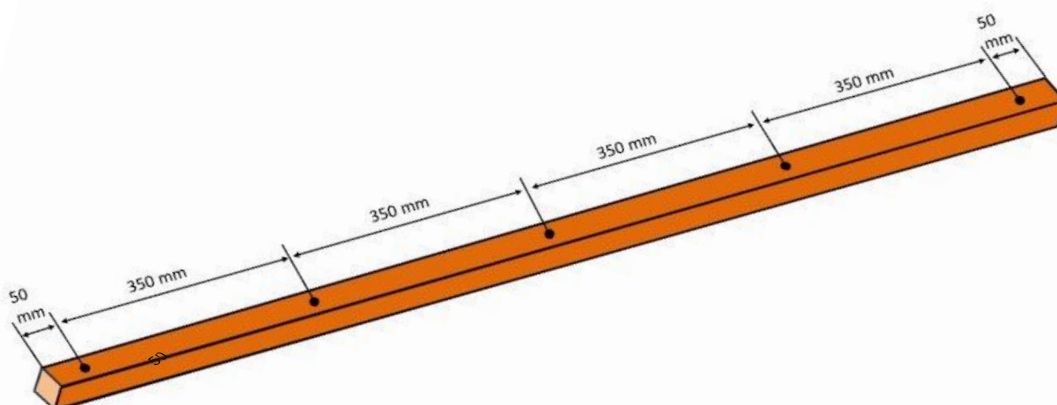

Drill holes with a diameter of 10 mm in the plastic bar if necessary.

**Note:** The hole positions shown in the diagram have been deliberately positioned to suit the stainless steel strip.

# SOFT BED HT

## 4GS WINGS ■ 8GS WINGS

### 2 Attach the end fastening

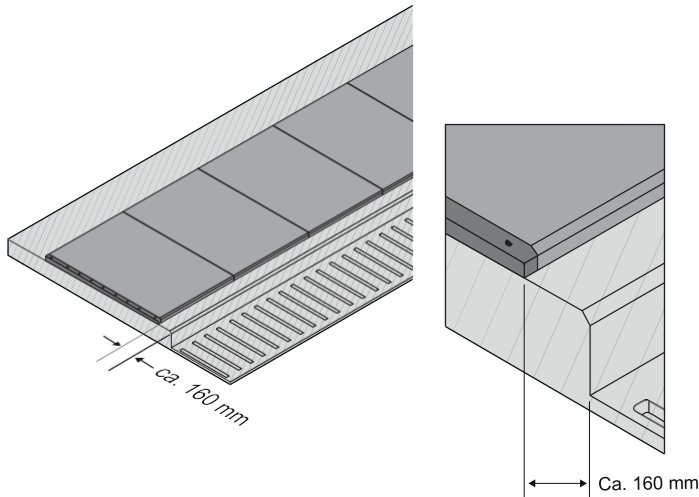

The 1500 mm long WINGS plastic bars are attached to the two end sections.

#### Steps

- A** Approx. 160 mm distance between the plastic bar and the rear concrete edge.
- B** Drill 10 mm diameter holes in the concrete to match the holes in the plastic bar.
- C** Insert the plastic dowels 10x100mm flush into the holes in the bar. (use a hammer if necessary)
- D** Screw in the A2 8 x100mm pan washer head screws flush.

### 3 Position composite foam sheets

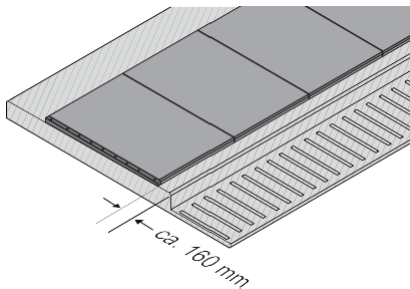

Place the foil-wrapped composite foam sheets approx. 160 mm from the rear concrete edge.

**Tip:** Mark the rear distance along the entire length, e.g. with a chalk line.

**Note:** Composite foam sheets must be placed tightly together. If the pre-wrapped foam sheets need to be cut to fit, seal the foil seams watertight using adhesive tape.

### 4 Unroll and align the top-cover sheet

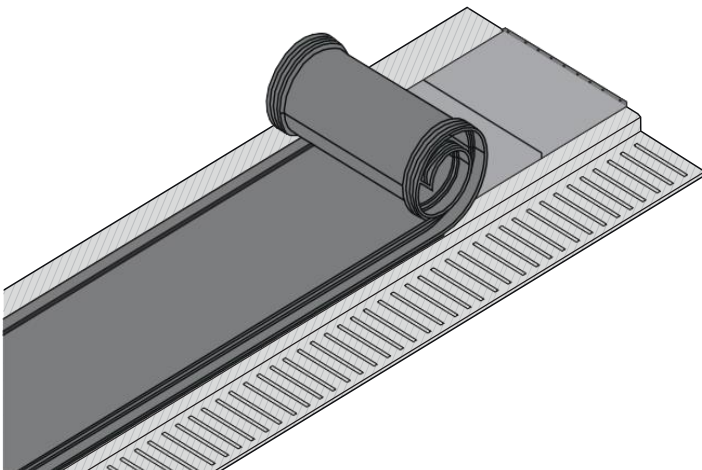

**Note:** If unrolling over the foam sheets is not possible, pull the cover sheet into position with care to avoid damaging the foil. After positioning, check the alignment of the composite foam sheets.

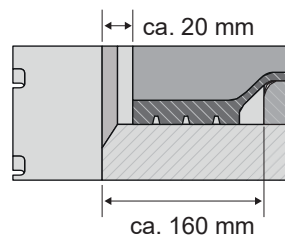

Maintain approx. 20 mm distance between the cover sheet and the rear concrete edge.

# SOFT BED HT

## 4GS WINGS ■ 8GS WINGS

### 5 Secure the cover sheet to one end face

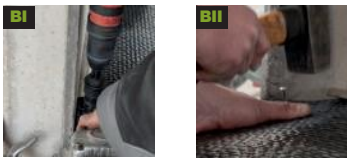
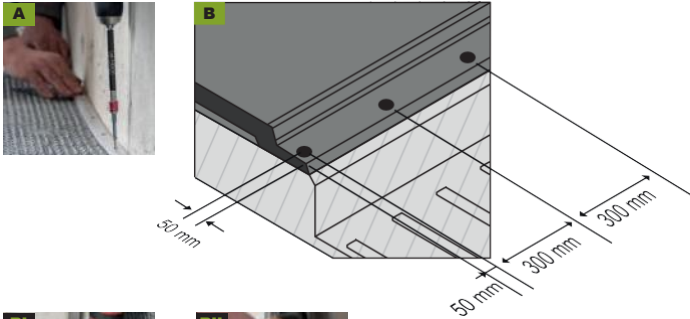

#### Steps

- A** Position the end of the endless rubber top-cover sheet on the WINGS plastic bar. Place the stainless-steel clamping strip on top of the sheet and screw it to the plastic bar using the stainless-steel screws.
- B** Drive in 3 nail-in anchors A2 10x80 into the head and foot areas. Approx. 50 mm, 350 mm and 650 mm distance from the end face. Distance of the fixing point: approx. 50 mm from the edge of the cover sheet in each case.
  - I** Pre-drill cover sheet  $\varnothing 11$  mm  
Drill the concrete  $\varnothing 10$  mm
  - II** Insert the plastic dowels flush into the holes in the cover sheet. Hammer in A2 10x80 nails with washer.

### 6 Tension the cover sheet



Tension the cover sheet by 1–1.5 % (1 % = 10 cm per 10 m). The tensioning device must distribute the load evenly across the width of the cover sheet. For example, use two rails — one on top, one underneath — and apply tension using chain hoists or tensioning straps.



#### Installation video

To get to the video, please scan the QR code!



**Tip:** If the cover sheet needs to be cut to its final length, proceed as follows: tension, measure, release tension, cut, and tension again.

### 7 Secure the cover sheet to the second end face

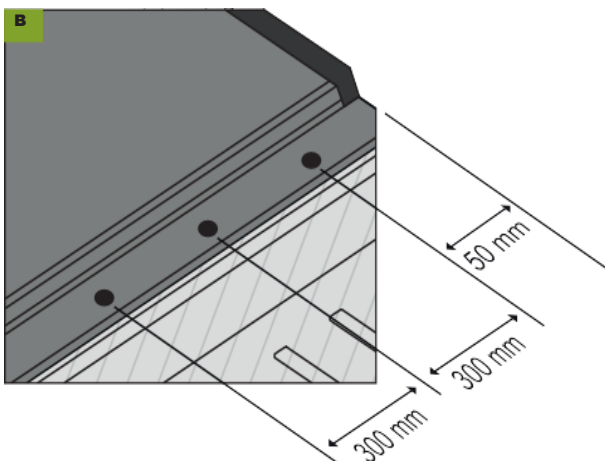

#### Steps

- A** Position the second end of the top-cover sheet on the WINGS plastic bar. Place the second clamping strip on top of the sheet and screw it to the plastic bar using the stainless-steel screws.
- B** Drive 3 A2 10x80 nail-in anchors into the head and foot areas. Approx. 50 mm, 350 mm and 650 mm distance from the end face. Distance of the fixing point: approx. 50 mm from the edge of the cover sheet in each case.

# SOFT BED HT

## 4GS ■ 8GS WINGS

### 7 Secure the cover sheet to the second end face

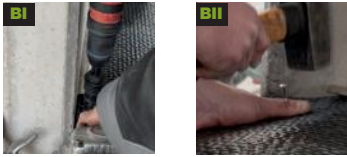

#### Steps

- I Pre-drill cover sheet: Ø 11 mm  
Drill the concrete: Ø 10 mm
- II Insert plastic dowels flush into the holes in the cover sheet.  
Hammer in A2 10x80 nails with washer.

**Tip:** Do not over-drive the nail anchors to avoid creating tension or bulging.

- C Once both ends are secured, remove the tensioning device

### 8 Secure the cover sheet in the head and foot areas

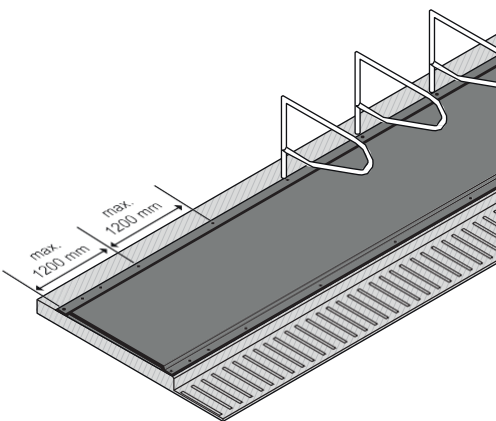

#### Steps

- A To complete the installation, secure the cover sheet along the head and foot edges at regular intervals of 1200 mm and approx. 50 mm from the edge of the cover sheet.
  - I Pre-drill the cover sheet Ø 11 mm  
Drill the concrete Ø 10 mm
  - II Insert the plastic dowels flush into the holes in the cover sheet. Hammer in A2 10x80 nails with washer.

**Tip:** Fixings positioned in the head area between the cubicle dividers and at the rear in line with them help to minimize potential contact with hooves.



#### Installation video



To get to the video, please scan the QR code!



#### Care and maintenance instructions

The rubber surfaces must be cleaned regularly. The cleaning agents must not damage the rubber surface. The rubber surface must be kept dry with suitable bedding material.

**Note:** Proper installation may vary depending on local conditions.  
No manufacturer's liability for installation damage.

Follow us on   

 [www.cow-comfort-huber.com](http://www.cow-comfort-huber.com)

Huber Technik Vertriebs GmbH

△ Robert-Bosch-Str. 8 · 85435 Erding · Germany

☎ +49 8122 869 122 · ✉ [vertrieb@huber-technik.de](mailto:vertrieb@huber-technik.de)