

## INSTALLATION GUIDE

# SOFT BED 4GS WINGS ■ 8GS WINGS

The HT 4GS WINGS and 8GS WINGS soft beds have been developed for use in high stalls made of concrete with a slight slope and self-supporting dividers. They consist of a rubber cover sheet and composite foam plates specially developed for dairy cattle farming.



For assembly you need

- ✓ Measuring tape or metre rule for measuring
- ✓ Chalk or pencil for marking (chalk line if necessary)
- ✓ Tensioning device incl. chain hoists/tensioning straps
- ✓ Drill with 8 mm and 10 mm drill bit
- ✓ Impact drill with 8 mm & 10 mm drill bit
- ✓ Hammer
- ✓ Knife
- ✓ Bit TX25 & TX 40



Fastening elements

- ✓ Nail anchor A2 8 x 80 with washer
- ✓ End fastening for WINGS systems consisting of plastic bar, 5x plastic douwels 10x100, 5x pan washer head screws 8x100 (A2), stainless steel clamping strip, stainless steel screws 5 x 40

### End fastening WINGS system

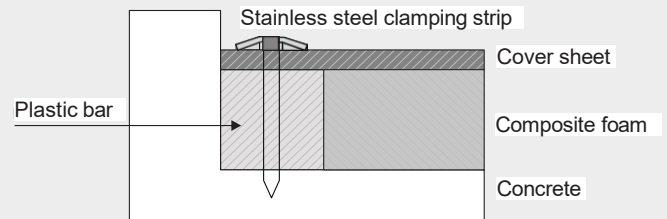

Requirements

- ✓ Prior to installation, the cover sheet must have been stored on the installation surface for at least 48 hours or for 7 days at room temperature so that the cover sheet reaches a uniform temperature.
- ✓ At ambient temperatures below 10 degrees Celsius, the installation must not be carried out.



Substrate/concrete requirements

- ✓ Level, firm, clean, dry and free of holes and protrusions.

Updated: August 1, 2025

## 1 Check plastic bar

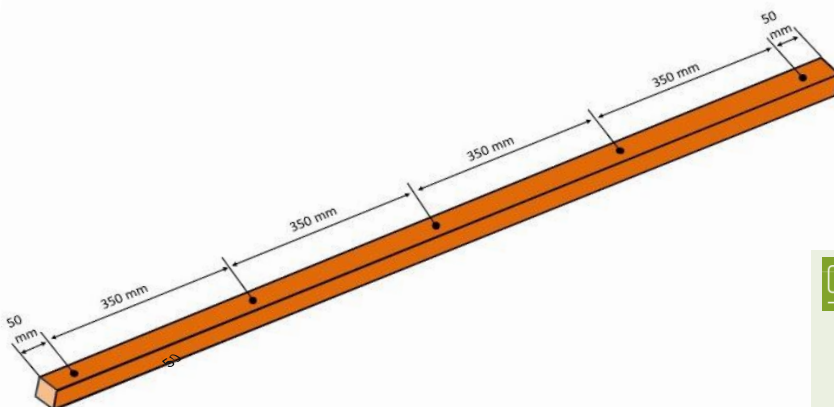

Drill holes with a diameter of 10 mm in the plastic bar if necessary.

**Note:** The positions of the holes shown in the diagram are matched to the corresponding stainless steel strip.



### Installation video

To get to the video, please scan the QR code!



# SOFT BED HT

## 4GS WINGS ■ 8GS WINGS

### 2 Attach the end fixing

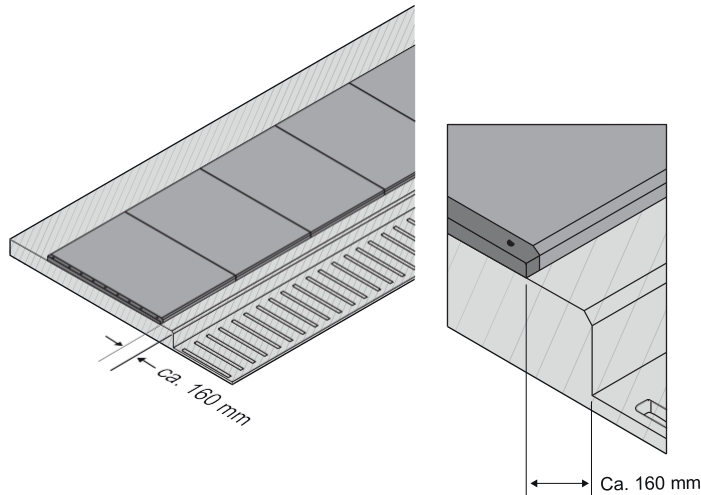

The 1500 mm long WINGS plastic bars are attached to the two end sections.

#### Steps

- A** Approx. 160 mm distance between the end moulding and the rear concrete edge.
- B** Drill 10 mm diameter holes in the concrete to match the holes in the plastic bar.
- C** Insert the plastic dowels 10x100 flush into the holes in the bar. (use a hammer if necessary)
- D** Screw in the A2 8 x100 pan washer head screws flush.

### 3 Laying out composite foam plates

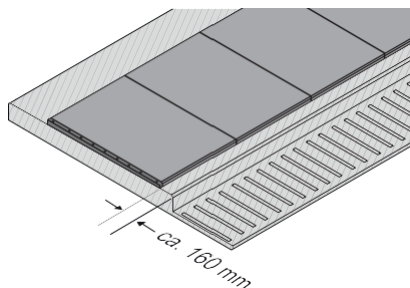

The foil-wrapped composite foam plates are laid at a distance of approx. 160 mm from the rear concrete edge.

**Tip:** Mark the distance in the rear area over the entire length the entire length, e.g. with a chalk line.

**Note:** The composite foam plates must lie close together. If the composite foam plates are cut to fit exactly, the foil must be glued watertight.

### 4 Roll out and align the cover sheet

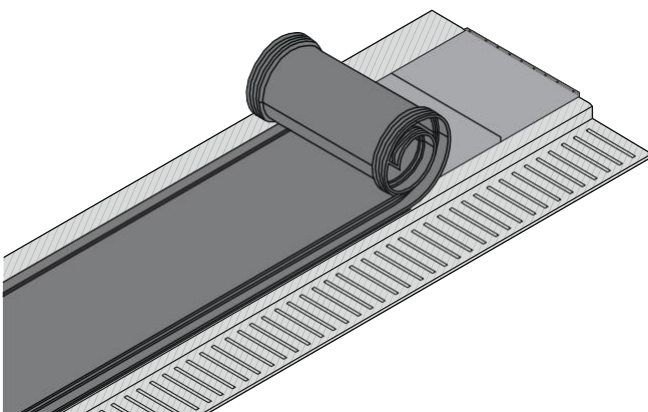

**Note:** If the cover sheet cannot be unrolled over the panels due to the installation, the unrolled sheet can also be pulled into position. Care must be taken to ensure that the foil is not damaged. The position of the composite foam plates should then be checked.

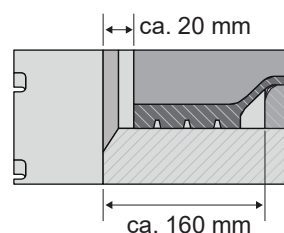

Approx. 20 mm distance between the cover sheet and the rear concrete edge.



#### Installation video

To get to the video, please scan the QR code!



# SOFT BED HT

## 4GS WINGS ■ 8GS WINGS

### 5 Fix the cover sheet to one end face

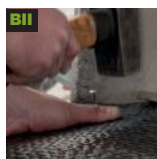
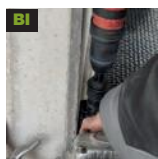
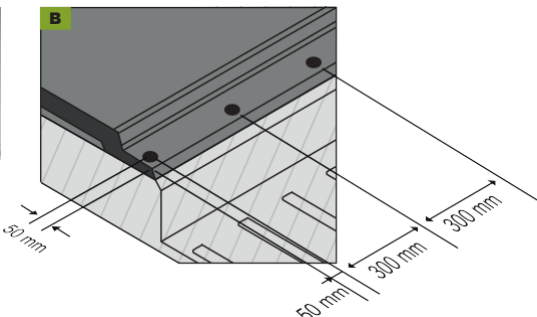

#### Steps

- A** The cover strip is screwed onto the plastic profile using the stainless steel clamping strip. Use the stainless steel screws for this.
- B** Drive 3 A2 8 x 80 nail plugs into the head and foot areas.  
Approx. 50 mm, 350 mm and 650 mm distance from the end face.
- I** Pre-drill cover sheet: 10 mm diameter  
Drill concrete: 8 mm diameter
- II** Insert the plastic dowels flush into the holes in the cover sheet. Drive in A2 8 x 80 nails with washer.

### 6 Prestressing the cover sheet



The cover sheet must be prestressed by 1-1.5 % (1 % corresponds to 10 cm per 10 m).

The tensioning device should distribute the tension exerted over the entire width of the cover sheet. For example, use 2 rails (one on the upper side, the second on the underside of the cover sheet). Chain hoists or tension belts can be used for tensioning.

**Tip:** It may be necessary to cut the membrane to the final length in an intermediate step >> tension, measure, relax, cut to size and tension again. The foil must be glued watertight.



#### Installation video

To get to the video,  
please scan the QR code!



### 7 Fix the cover sheet to the second end face

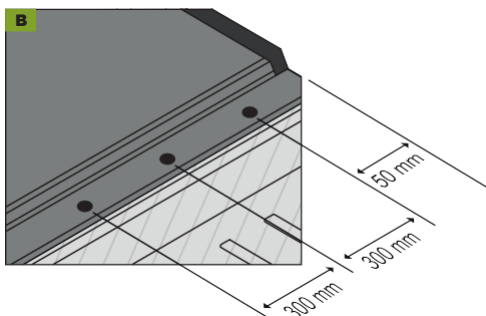

#### Steps

- A** The cover strip is screwed onto the plastic strip using the stainless steel clamping strip. Use the stainless steel screws 5x40 for this.
- B** Drive 3 A2 8 x 80 nail plugs into the head and foot areas.  
Approx. 50 mm, 350 mm and 650 mm distance from the end face to the holes in the plastic strip.  
Distance of the fixing point: approx. 50 mm from the edge of the cover sheet in each case.



#### Installation video

To get to the video,  
please scan the QR code!



# SOFT BED HT

## 4GS ■ 8GS WINGS

### 7 Fix the cover sheet to the second end face



#### Steps

- I** Pre-drill cover sheet: 10 mm diameter  
Drill concrete: 8 mm diameter
- II** Insert plastic dowels flush into the holes in the cover sheet.  
Drive in A2 8x80 nails with washer.

**Tip:** Do not drive the nail plugs in too far so that no tension or bulging occurs.

- C** Once the cover sheet has been fixed on both ends, the tensioning device can be removed!

### 8 Fix the cover sheet in the head and foot area

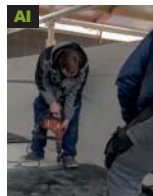
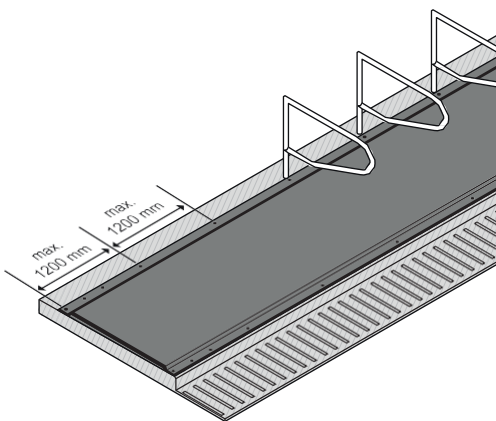

#### Steps

- A** Fasten at a max. distance of 1200 mm in the area of the separating brackets and approx. 50 mm from the edge of the cover sheet.
- I** Pre-drill cover sheet: 10 mm drill bit  
Drill concrete: 8 mm drill bit
- II** Insert the plastic dowels flush into the holes in the cover sheet. Drive in A2 8 x 80 nails with washer.

#### o I

#### Care and maintenance instructions

The rubber surfaces must be cleaned regularly. The cleaning agents must not attack the rubber surface.  
The rubber surface must be kept dry with suitable bedding material.

**Note:** Proper installation may vary depending on local conditions.  
No manufacturer's liability for installation damage.

# SOFT BED HT

## 4GS ■ 8GS WINGS



Nail anchor A2 8 x 80 with washer



Screw A2 5 x 40



Dowel 8x100 & pan washer head screw 8x100